

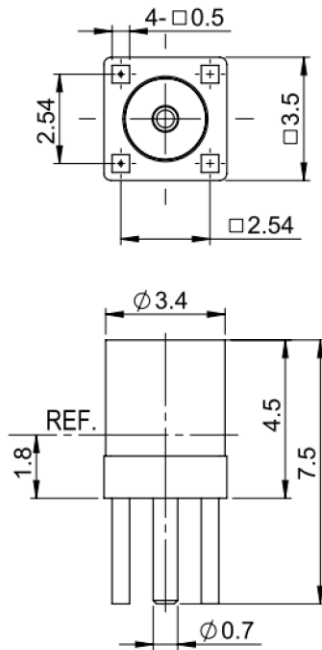

PAGE 1/2	ISSUE 1422A	SERIES ECO MMCX	PART NUMBER R110A426000
----------	-------------	-----------------	-------------------------



Australian Representatives
ROJONE, PTY LTD.
 Tel: 02 9829 1555
 E: sales@rojone.com.au
 www.rojone.com.au



PANEL CUT OUT



A DIA
5 holes

mm		
	Maxi	mini
A	0.85	0.75
B	2.56	2.52

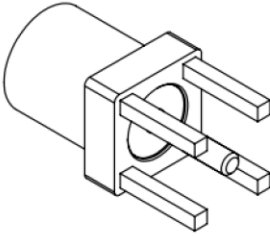
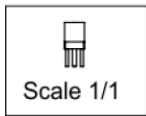

All dimensions are in mm.

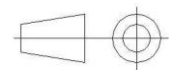

COMPONENTS	MATERIALS	PLATING (µm)
Body	BRASS	GOLD
Center contact	BERYLLIUM COPPER	GOLD
Outer contact		
Insulator	PTFE	
Gasket		
Others parts		
-	-	-
-	-	-

PAGE 2/2	ISSUE 1422A	SERIES ECO MMCX	PART NUMBER R110A426000
----------	-------------	------------------------	--------------------------------

PACKAGING

Standard	Unit	Other
100	Contact us	Contact us

ELECTRICAL CHARACTERISTICS

Impedance		50	Ω
Frequency		0-3	GHz
VSWR	1.35* +	0	x F(GHz) Maxi
Insertion loss		0.15*	√F(GHz) dB Maxi
RF leakage	- (NA	- F(GHz) dB Maxi
Voltage rating		170	Veff Maxi
Dielectric withstanding voltage		250	Veff mini
Insulation resistance		1000	MΩ mini

ENVIRONMENTAL

Operating temperature	-40/+85	°C
Hermetic seal	NA	Atm.cm3/s
Panel leakage	NA	

MECHANICAL CHARACTERISTICS

Center contact retention			
Axial force – Mating End		10	N mini
Axial force – Opposite end		10	N mini
Torque		NA	N.cm mini
Recommended torque			
Mating		NA	N.cm
Panel nut		NA	N.cm
Mating life		100	Cycles mini
Weight		0.27	g

SPECIFICATION

OTHER CHARACTERISTICS

Assembly instruction:

Others:

***COAXIAL TRANSMISSION LINE ONLY**